

## Polyethylene Repair Products

### Repair Patch, Melt Stick, Liquid Epoxy and Mastic Filler

#### Pipeline Repair Products

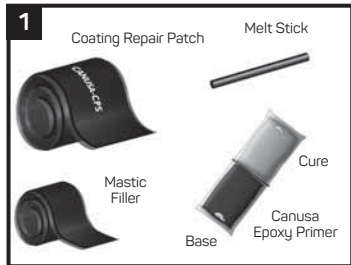

The Coating Repair Patch (CRP) is typically shipped in bulk rolls and can be cut-to-size in the field. Melt Sticks and Mastic Fillers are used to repair holidays and/or fill voids. Canusa Liquid Epoxy is supplied in pre-measured quantities.

#### Equipment List

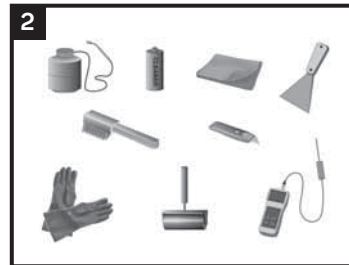

Propane tank, hose, torch & regulator; Appropriate tools for surface abrasion and cleaning, including wire brush, abrasive paper, rags & approved cleaner; Temperature measuring device; Misc. tools such as; knife, putty knife, roller, paint brush or paint roller, tape measure, and marker; Standard safety equipment; gloves, goggles, hard hat, etc.

#### Removal of Damaged Coating

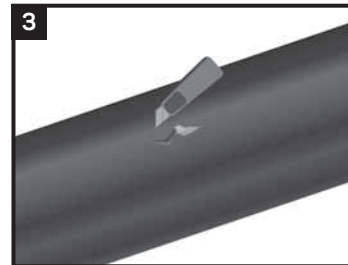

Remove damaged coating with a knife or hand grinder to prevent crack propagation in the coating.

#### Solvent Cleaning

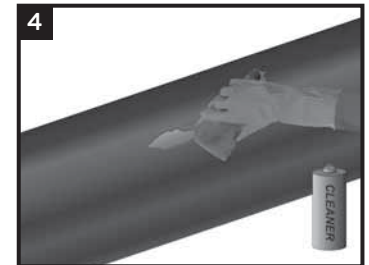

Clean exposed steel and adjacent pipe coating with an approved cleaner (as per SSPC-SP-1) to remove the presence of oil, grease and other contaminants.

#### Surface Preparation

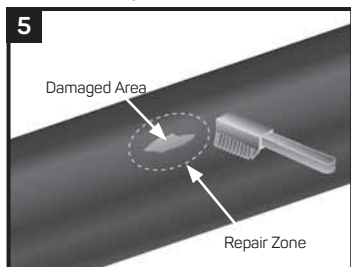

Remove adhering rust, coating chalk, dirt, and roughen the mill applied coating in the repair zone using an abrasive paper/cloth or wire brush.

#### Liquid Epoxy

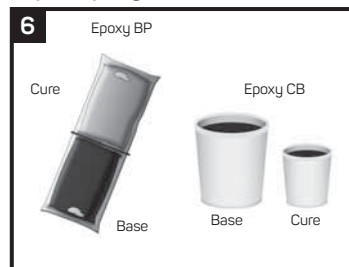

Follow the Preparation, Mixing and Application instructions provided with the supplied Canusa Epoxy Pack. For bulk quantities: mix the primer cure with the primer base (See Liquid Epoxy Product Data Sheet for Mixing Ratio). Stir for a minimum of 30 seconds to assure uniform mixture.

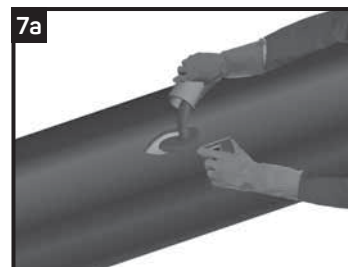

Apply mixed epoxy to a minimum uniform thickness of 100 microns (4 mils) on all exposed bare metal.

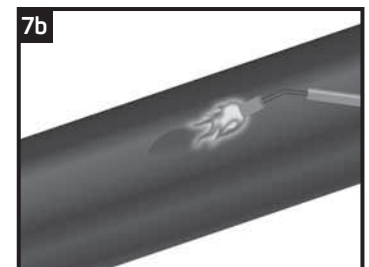

Preheat the area with a low to moderate intensity flame to substantially cure the epoxy and warm the surface. Skip to box 10.

#### Melt Stick Application For Damage Up To 10mm x 10mm

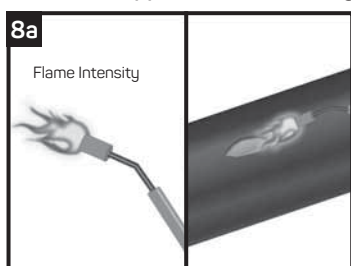

Use a low intensity yellow flame for pre-heating the coating and applying the repair products. With quick back and forth strokes, pre-heat the repair zone sufficiently to remove moisture and assist in adhesion.

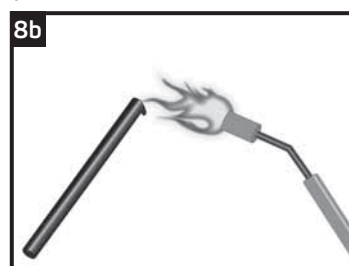

Heat the melt stick with the torch until it becomes fluid.

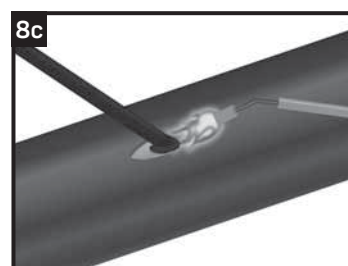

Heat the melt stick and the repair zone simultaneously with the torch and spread the melt stick over the damaged area. Keep the flame moving to prevent damage to the coating. Some ignition of the melt stick is acceptable.

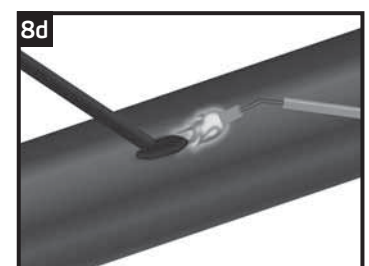

Continue spreading the melt stick over the repair zone until the entire area is covered. After sufficient melt stick material is on the surface, apply additional heat in quick back-and-forth strokes to create a smooth surface.

## Mastic Filler Installation



Ensure that the melt stick material completely covers the repair zone. The melt stick material should be spread liberally so that the material is raised above the coating surface.



Fill deeper crevices with Canusa Mastic Filler (MF). Unroll the filler material and cut off the required amount, leaving the release paper in place.

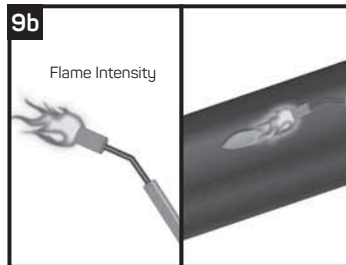

Use a low intensity yellow flame for pre-heating the coating and applying the repair products. With quick back and forth strokes, pre-heat the repair zone sufficiently to remove moisture and assist in adhesion.

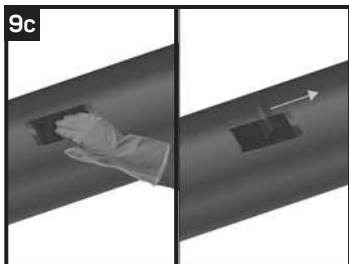

Place the filler material onto the damaged area with the release paper facing up. Firmly press the material into the damaged area by hand and remove the release paper.

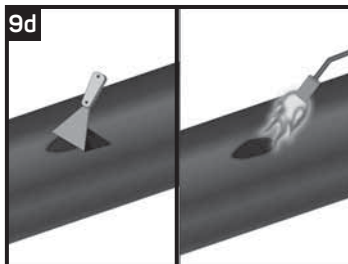

After filling the damaged area, remove the excess filler to create a smooth surface. As an option, use a low intensity yellow flame to warm the filler material and assist in smoothing it out.

## Patch Preparation

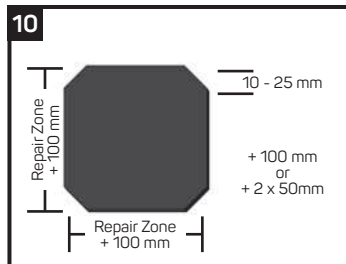

Cut a patch of CRP large enough to extend a minimum of 50mm (2") beyond the edge of the repair zone. Trim each corner of the patch about 10-25mm (½" - 1") at a 45° angle. If the damage has a diameter greater than 10cm (4"), use an appropriate heat-shrinkable sleeve. For application of CRP-PE, refer to the "Polyethylene Repair Products - CRP-PE" Install Guide.

## Pre-Heat

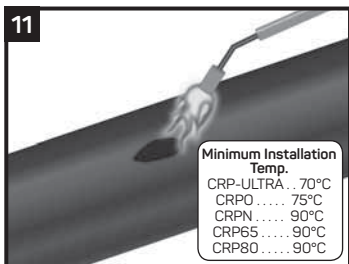

Warm the damaged area (repair zone + 50mm (2") overlap) to remove moisture and assist in adhesion.

## Patch Installation

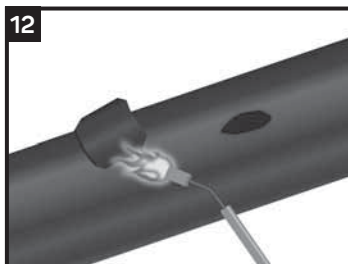

After removing the release liner from the cut patch, place the patch with the adhesive side up on a gloved hand, or on top of the pipe, and heat gently. Heat until the adhesive softens and the surface becomes glossy. Also, reheat the damaged area to keep it warm.

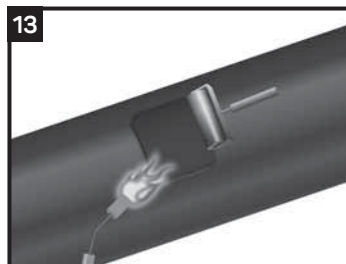

Apply the softened adhesive side of the patch to the damaged area and press down firmly. Heat the patch with a low intensity flame, and using a roller or a gloved hand, pat down and remove wrinkles. Roll to ensure a good bond.

## Inspection



Visually inspect the installed patch for the following:

- Patch is in full contact with the pipe coating.
- There are no loose edges.
- A successful patch has adhesive flow on the edges.
- The patch has fully conformed to the coating.
- No cracks or holes in patch backing.

## Backfilling Guidelines

After application, allow the repaired area to cool before backfilling. To prevent damage to the repaired material, use selected backfill material (no sharp stones or large particles).

## Storage & Safety Guidelines

To ensure maximum performance, store Canusa products in a dry, ventilated area. Keep products sealed in original cartons and avoid exposure to direct sunlight, rain, snow, dust or other adverse environmental elements. Avoid prolonged storage at temperatures above 35°C (95°F) or below -20°C (-4°F). Product installation should be done in accordance with local health and safety regulations.

These installation instructions are intended as a guide for standard products. Consult your Canusa representative for specific projects or unique applications.

## Canusa-CPS A division of Shawcor Ltd.

### Head Office

25 Bethridge Road  
Toronto, ON, Canada M9W 1M7  
Tel: +1 416 743 7111  
Fax: +1 416 743 5927

### Canada

Dome Tower St. 2200,  
333-7th Avenue SW  
Calgary, AB, Canada T2P 2Z1  
Tel: +1 403 218 8207  
Fax: +1 403 264 3649

### Americas

5875 N. Sam Houston Pkwy W.,  
Suite 200  
Houston, TX, USA 77086  
Tel: +1 281 886 2350  
Fax: +1 281 886 2353

### Middle East

ADPC - Mussafah Port,  
P.O. Box 2621  
Abu Dhabi, UAE  
Tel: +971 2 496 3500  
Fax: +971 2 496 3501

### Europe, Africa & Russia

Dellaertweg 9-E, Gebouw  
"Le Carrefour"  
2316 WZ Leiden,  
The Netherlands (NL)  
Tel: +31 71 80 802 70  
Fax: +31 71 80 802 71

### Asia-Pacific

101 Thomson Road,  
#11-03 United Square  
307591 Singapore  
Tel: +65 6749 8918  
Fax: +65 6749 8919

## Quality Management system registered to ISO 9001

Canusa warrants that the product conforms to its chemical and physical description and is appropriate for the use stated on the installation guide when used in compliance with Canusa's written instructions. Since many installation factors are beyond our control, the user shall determine the suitability of the products for the intended use and assume all risks and liabilities in connection therewith. Canusa's liability is stated in the standard terms and conditions of sale. Canusa makes no other warranty either expressed or implied. All information contained in this installation guide is to be used as a guide and is subject to change without notice. This installation guide supersedes all previous installation guides on this product. E&OE

Part No. 99060-011  
IG\_PR\_P(PE)\_rev017