

Factory Grade PE Repair Products

Polyethylene-based coating repair products for corrosion protection

Canusa's Factory Grade PE Repair Products for factory-applied 3LPE coating provide excellent adhesion and shear resistance at high pipeline operating temperatures. The polyethylene repair patch has been uniquely designed to be fully compatible with the polyethylene pipeline coating. The melt stick is also made from polyethylene for maximum compatibility. These aspects ensure compatibility throughout the range of Canusa products offered.

Coating Repair Patch (CRP-PE)

- Consists of an irradiated, cross-linked polyolefin sheet coated with a heat-activated adhesive, designed specifically for sealing and protection of damaged pipeline coatings up to 150mm x 150mm in size.
- Fast installation with no special tools required, providing a barrier to moisture and corrosion with resistance to abrasion and shear forces during pipeline installation and while in-service.

Melt Sticks (MS)

- Melt Sticks are heat-activated adhesives supplied as a rod for ease of application and are ideal for small coating repairs ranging from superficial damage to holidays and cracks up to 10mm x 10mm.

Liquid Epoxy

- Acts as an initial corrosion protection layer for major repairs when the damaged area extends to the steel surface.
- Unique force cure technology ensures consistent thickness prior to installation of the adhesive filler material and repair patch.



Applications



Oil & Gas



Water Pipelines



Repair & Rehab

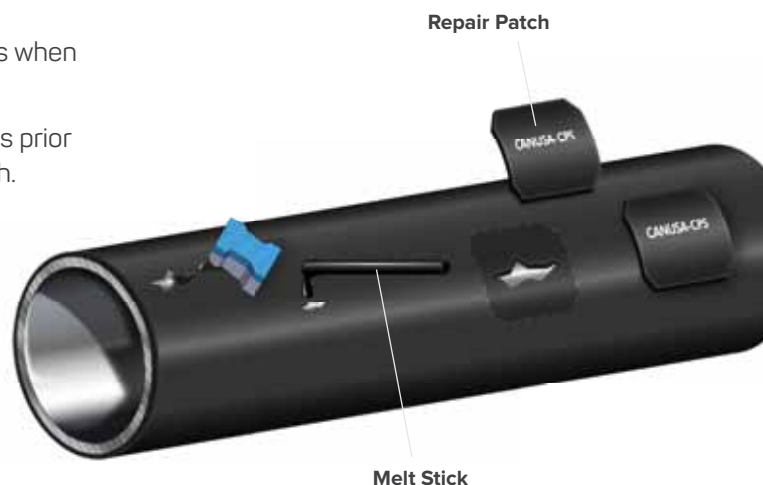

Factory Grade PE Repair Products

Polyethylene-based coating repair products for corrosion protection

Patch Operating Characteristics		CRP-PE
Pipeline Operating Temp.		Up to 100°C (212°F)*
Minimum Installation Temp.		125°C (257°F)**
Mainline Coating Compatibility		3LPE, FBE
Adhesive Properties		Test Method
Softening Point	ASTM E28	> 150°C
Lap Shear @ 23°C	EN 12068	> 450 N/cm ²
Backing Properties		
Tensile Strength	ISO 527	22 MPa
Elongation	ISO 527	600%
Hardness	ISO 868	55 Shore D
Volume Resistivity	ASTM D257	10 ¹⁷ ohm-cm
Patch Properties		
Adhesion Strength @ 23°C	ISO 21809-1	> 120 N/cm
Impact Resistance	ISO 21809-1	7 J/mm
Indentation Resistance @ 80°C	DIN 30670	0.4 mm
Cathodic Disbondment† @ 23°C, 28 days	ISO 21809-1	< 3 mm

* Actual temperature rating is dependant on specific project requirements and conditions. Please consult your local Canusa representative.

** Canusa-CPS recommended installation temperature.

† CRP-PE installed with Canusa Liquid Epoxy. Epoxy is required when damage extends to steel.

Melt Stick Properties	Test Method	Typical Values
Softening Point	ASTM E28	124°C
Lap Shear @ 23°C	EN 12068	> 300 N/cm ²



The product information shown here is intended as a guide for standard products.

Consult your Canusa representative for specific projects or unique applications.

Canusa-CPS
A division of Shawcor Ltd.

Head Office

25 Bethridge Road
Toronto, ON, Canada M9W 1M7
Tel: +1 416 743 7111
Fax: +1 416 743 5927

Canada

Dome Tower St. 2200, 333-7th Avenue SW
Calgary, AB, Canada T2P 2Z1
Tel: +1 403 218 8207
Fax: +1 403 264 3649

Americas

5875 N. Sam Houston Pkwy W., Suite 200
Houston, TX, USA 77086
Tel: +1 281 886 2350
Fax: +1 281 886 2353

Middle East

ADPC - Mussafah Port, P.O. Box 2621
Abu Dhabi, UAE
Tel: +971 2 496 3500
Fax: +971 2 496 3501

Europe, Africa & Russia

Dellaertweg 9-E, Gebouw "Le Carrefour"
2316 WZ Leiden, The Netherlands (NL)
Tel: +31 71 80 802 70
Fax: +31 71 80 802 71

Asia-Pacific

101 Thomson Road, #11-03 United Square
307591 Singapore
Tel: +65 6749 8918
Fax: +65 6749 8919

**Quality Management system
registered to ISO 9001**

Canusa warrants that the product conforms to its chemical and physical description and is appropriate for the use stated on the product data sheet when used in compliance with Canusa's written instructions. Since many installation factors are beyond our control, the user shall determine the suitability of the products for the intended use and assume all risks and liabilities in connection therewith. Canusa's liability is stated in the standard terms and conditions of sale. Canusa makes no other warranty either expressed or implied. All information contained in this data sheet is to be used as a guide and is subject to change without notice. This data sheet supersedes all previous data sheets on this product. E&OE

PDS_FG_PRP (PE)_rev012

Since 1967, Canusa-CPS has been a leading developer and manufacturer of specialty pipeline coatings for the sealing and corrosion protection of pipeline joints and other substrates. Canusa-CPS high performance products are manufactured to the highest quality standards and are available in a number of configurations to accommodate many specific project applications.

CANUSA-CPS

**Pipeline corrosion
Protection**